

REV		DESCRIPTION	版本说明			
DATE	REVISION	DESCRIPTION	DESIGNED	CHECKED	VERIFIED	APPROVED
日期	版本	描述	设计	校对	审核	审定
2022-03-20	A	船东船级社校审前 Before owner and class for Approval				

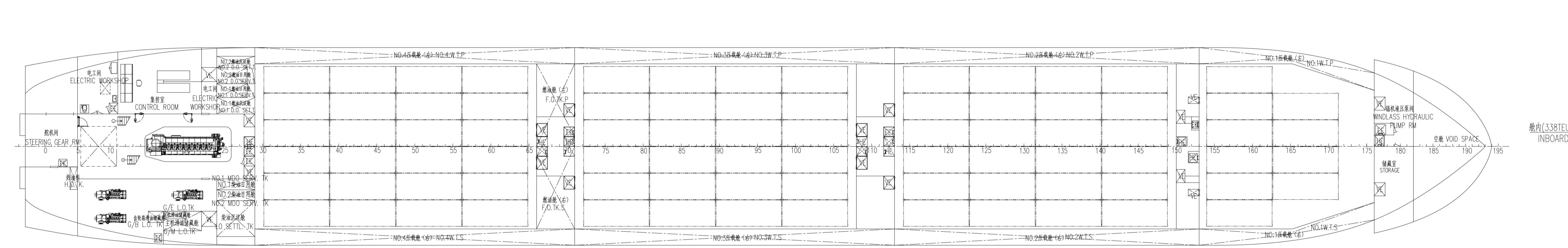
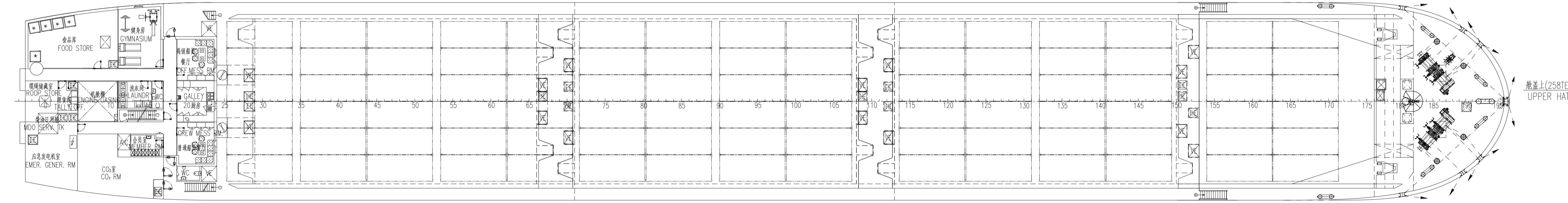
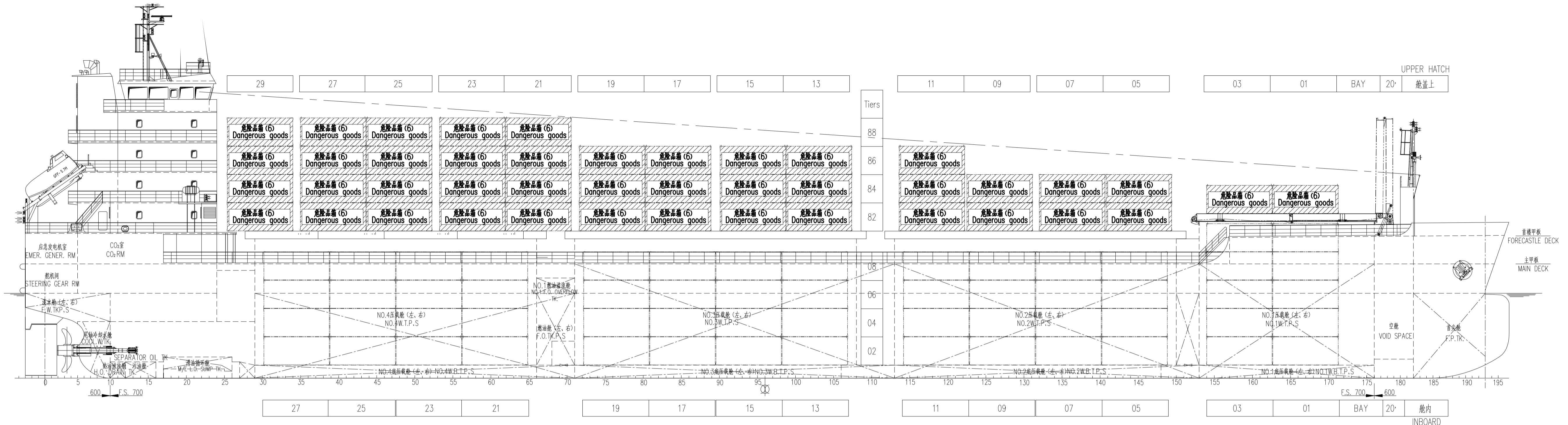

集装箱装载说明:
1. 装载集装箱时, 20英尺集装箱共596个, 货舱内集装箱共有338个, 舱盖上集装箱共有258个。舱盖上允许装载危险品箱, 危险品限2-6,8,9类。具体布置如侧视图所示。

INSTRUCTIONS: This ship can carry 20' containers, a total of 596 TEU. A total of 338 TEU containers are loaded in the cargo hold, a total of 258 TEU containers are loaded on the hatch cover. Containers of dangerous goods can be loaded on the hatch cover. Dangerous goods are limited to 2-6,8,9 categories. The specific arrangement is shown in the side view.

CURRENT REVISION		WU ZHOU GLORY		JK476-022-035	
MARKS NUM	REVISION NO.	SIGN	DATE	WEIGHT(kg)	SCALE
标记	数量	修改单号	签字	重量(公斤)	比例
	A				1:200
DOWN					
CHKO	曹文特	DATE	2022.03		
CHKD	李希	DATE	2022.03		
RVE		DATE			
STD		DATE			
APP	周国泉	DATE	2022.03		

CONTAINER LOADING ARRANGEMENT

集装箱装载布置图

AREA	TOTAL	PAGE
总面积	共 2 页	第 1 页
m ²		

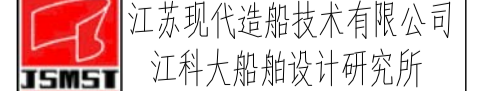

This drawing and the information contained is the exclusive property of SDH of JUST and must not be copied or handed over to third parties without our written permission.
本图(文件)及所含内容均知识产权属于江科大船舶设计研究院, 未经本所书面许可, 任何人不得复制或转交第三方。

DATE	REVISION	DESCRIPTION	DESIGNED	CHECKED	VERIFIED	APPROVED
日期	版本	简述	设计	校对	审核	审定
2022-03-20	A	船东船级社校审前 Before owner and class for Approval				

集装箱工况一混箱：舱内164TEUX28.5T,174TEUX10T;舱盖190TEUX10T,168TEUX2.5T;总重量7734t,重心垂向位置距基线为7.152m,重心纵向位置距船中为-0.079m,重心横向位置距船中线为0m;
Container condition loadcase1 mix container;inboard 164TEUX28.5T,174TEUX10T;upper hatch 90TEUX10T,168TEUX2.5T;total mass 7734t,the vertical position of the center of gravity is 7.152m from B.L., the longitudinal position of the center of gravity is -0.079m from M.D,the transverse position of the center of gravity is 0m from C.L.

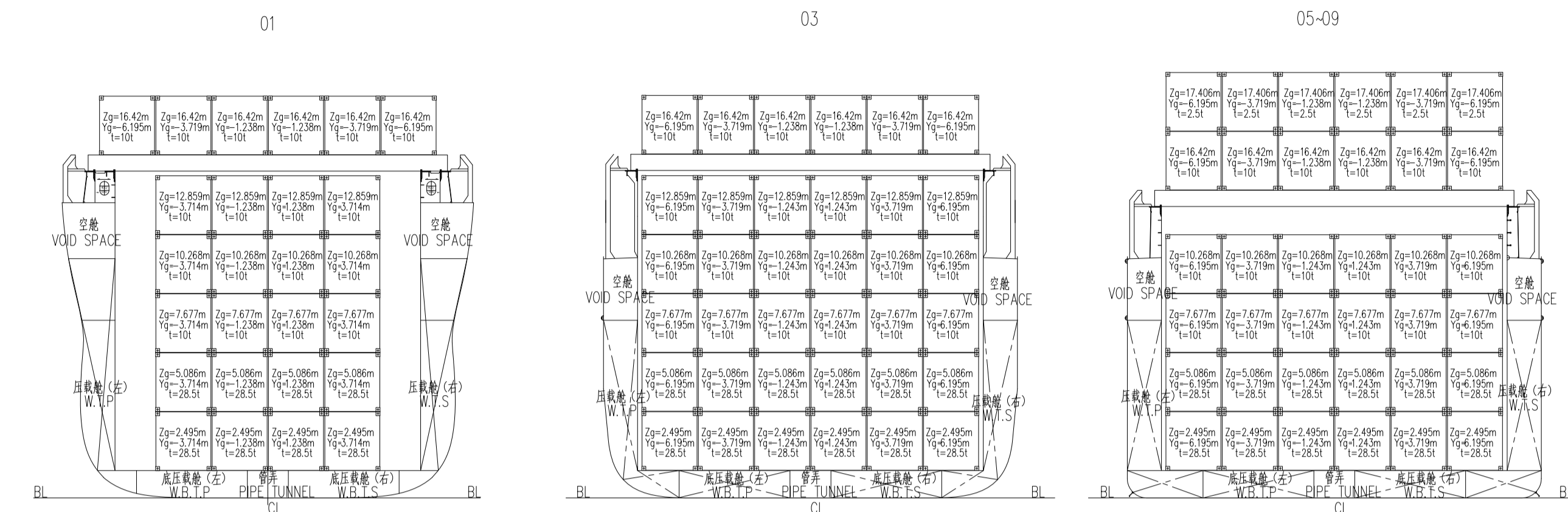

集装箱工况二均箱 (5.0T)：舱内338TEUX5.0T;舱盖258TEUX5.0T;总重量2980t,重心垂向位置距基线为11.421m,重心纵向位置距船中为-2.559m,重心横向位置距船中线为0m;
Container condition loadcase2 average quality (5.0t):inboard 338TEUX5.0T;upper hatch 258TEUX5.0T;total mass 2980t,the vertical position of the center of gravity is 11.421m from B.L., the longitudinal position of the center of gravity is -2.559m from M.D,the transverse position of the center of gravity is 0m from C.L.

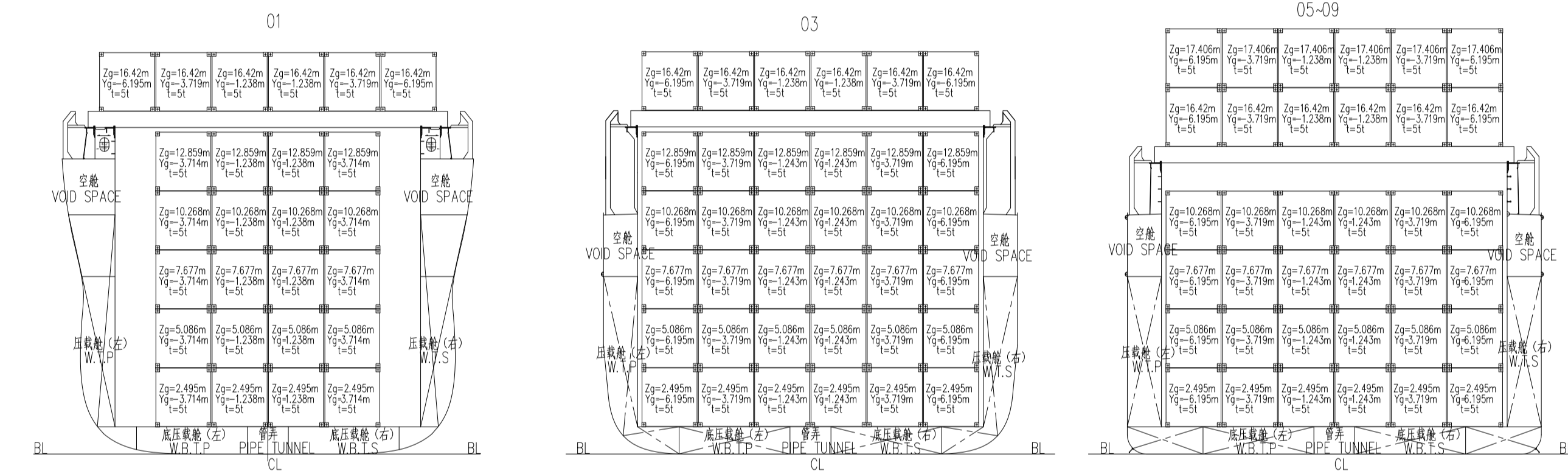

集装箱工况三空箱 (2.5T)：舱内338TEUX2.5T;舱盖258TEUX2.5T;总重量1490t,重心垂向位置距基线为11.421m,重心纵向位置距船中为-2.559m,重心横向位置距船中线为0m;
Container condition loadcase3 average quality (2.5t):inboard 338TEUX2.5T;upper hatch 258TEUX2.5T;total mass 1490t,the vertical position of the center of gravity is 11.421m from B.L., the longitudinal position of the center of gravity is -2.559m from M.D,the transverse position of the center of gravity is 0m from C.L.

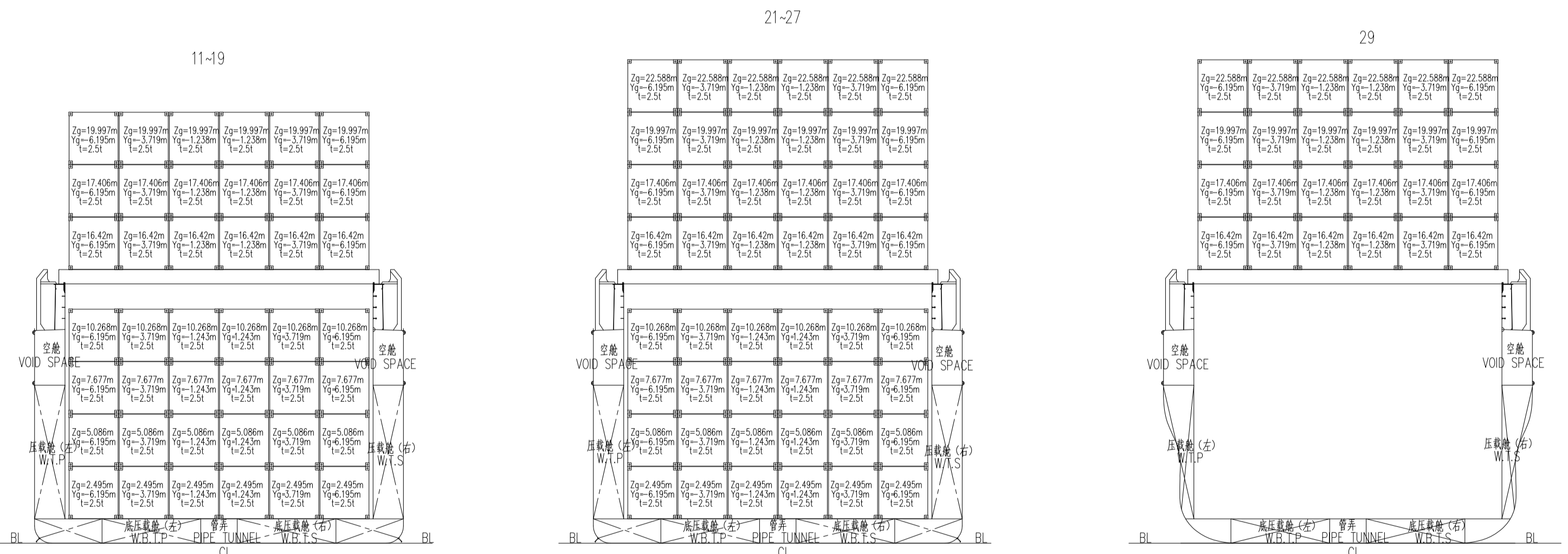
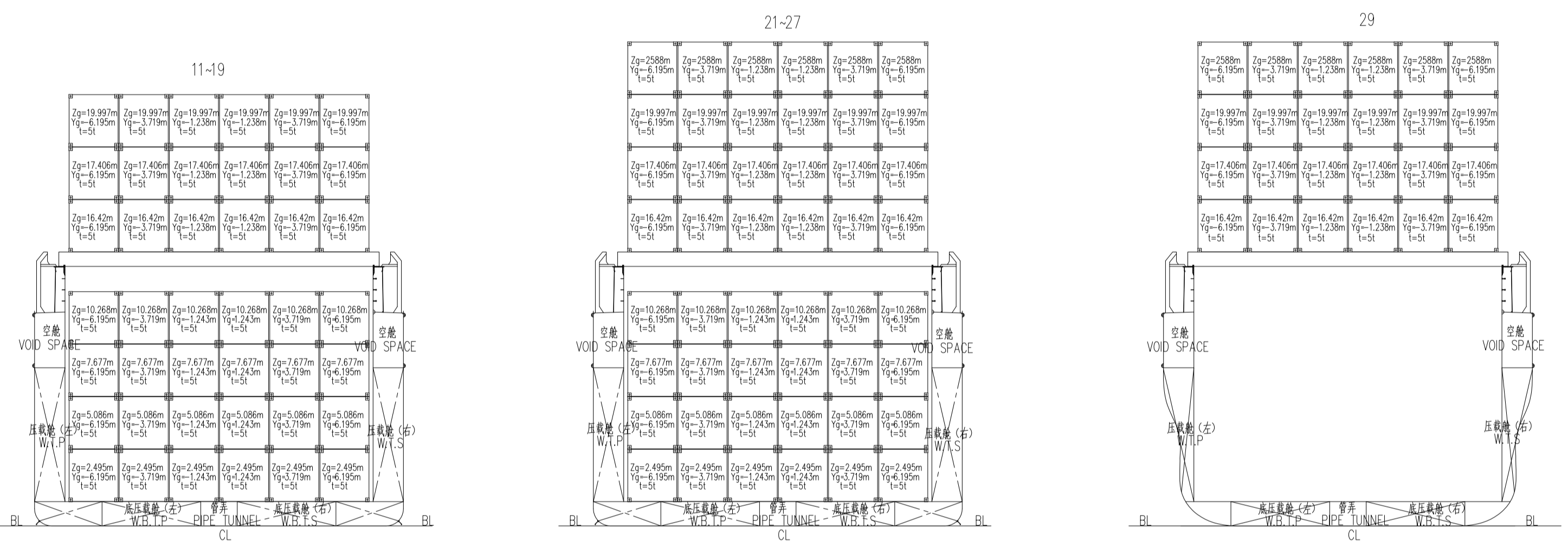
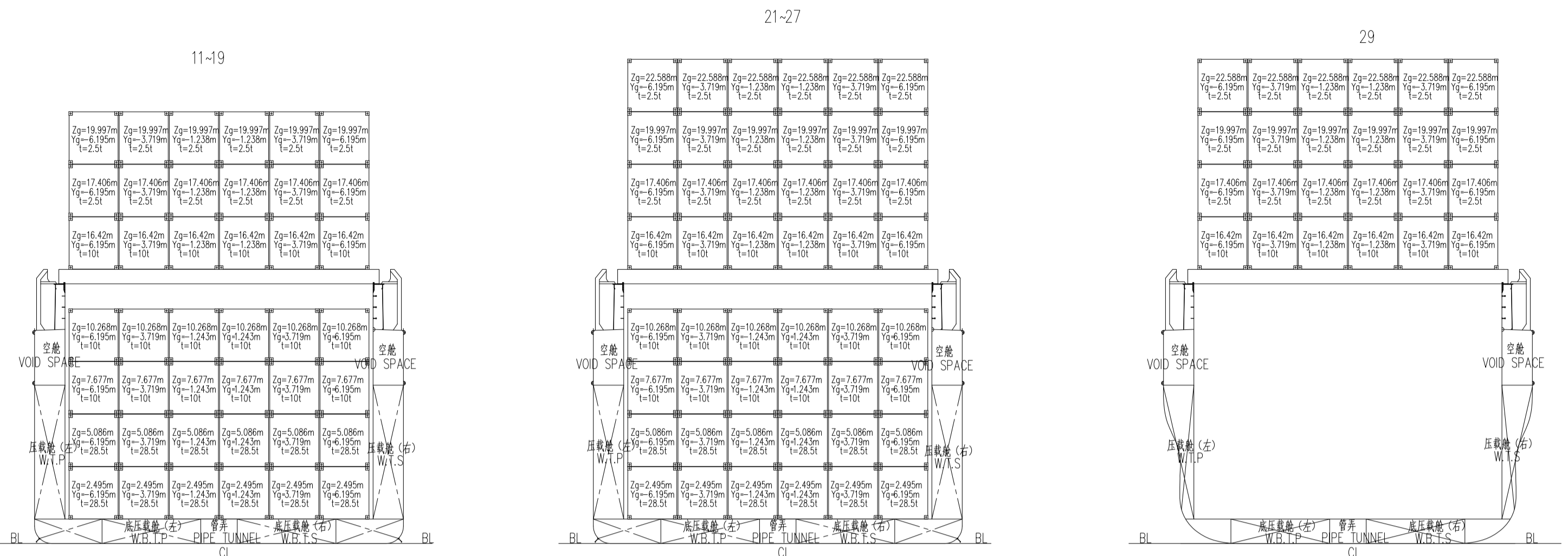
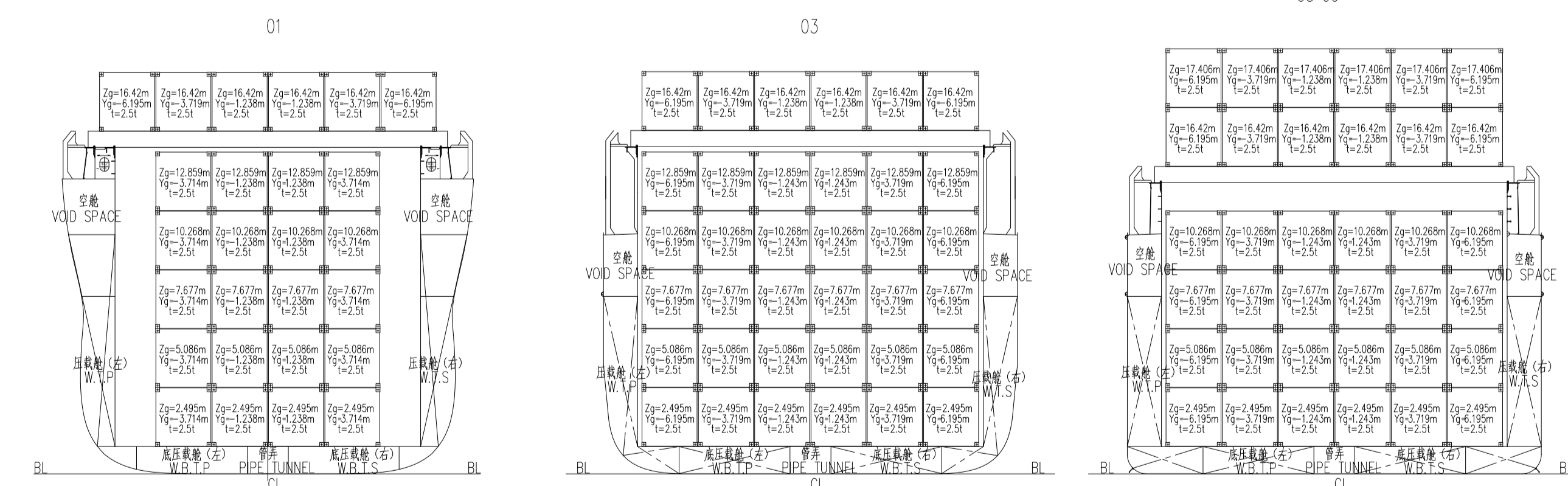

- 说明:
- 本船设计总箱位为596TEU箱位,箱位如图所示。
 - 本船各装载状态稳性计算满足规范要求。
 - 本图所示集装箱各装载状态的布置及重量重心分布情况。
 - 本图所有选用的底座及绑扎设备均须持有船检相关证书。

- NOTE:
- The design of the ship's total container space is 596 TEUs,as shown in the figure.
 - All of the ship's container loading conditions meet the requirements of the rules through stability calculation.
 - The picture shows the layout and weight center distribution of each loading condition of the container.
 - All bases and lashing equipment selected for this drawing must hold relevant certificates for ship inspection.

DETAIL DESIGN 详细设计		WU ZHOU GLORY	
CURRENT REVISION 当前版本	A		
MARKS NUM 标志数量	REVISION NO. 修改单号	SIGN 签字	DATE 日期
2	1	曹文特	2022.03
CHK 审核	DATE 日期	2022.03	
DVE 校对	DATE 日期	2022.03	
STD 审核	DATE 日期	2022.03	
APP 审核	DATE 日期	2022.03	

CONTAINER LOADING ARRANGEMENT
集装箱装载布置图

WEIGHT(kg) 重量(公斤)	SCALE 比例
	1:200
AREA 总面积:	TOTAL PAGE 共 2 页
m ²	第 2 页

江苏现代造船技术有限公司
JK476-022-035
江科大船设计研究所

This drawing and the information contained is the exclusive property of SDH of JUST and must not be copied or handed over to third parties without our written permission.
本图(文件)及所含全部知识产权属于江科大船舶设计研究所,未经本所书面许可,任何人不得复制或转交第三方。